



Elasto-Valve Rubber Products Inc.
1691 Pioneer Rd.
Sudbury, Ont. Canada
P3G-1B2

Tel 1-705-523-2026
Fax 1-705-523-2033
Toll Free 1-800-461-6331

PETITE PINCH VALVE

INSTALLATION, OPERATION, MAINTENANCE INSTRUCTIONS

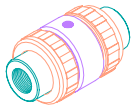

TYPE TU

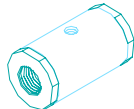

TYPE SE



TYPE MP

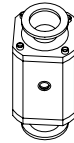

TYPE QC

PETITE PINCH VALVES

INSTALLATION

E.V.R. Petite Pinch Valves Type “SE”, “TU”, “MP”, & “QC” should not require any further tightening of their “end caps” or “union nuts” respectively. This may cause the rubber sleeve to twist in its seat & cause leakage. Due to moulding & machining tolerances a slight gap may be visible between the end caps or union nuts and the body. **DO NOT** tighten any further.

The Petite Pinch Valves are supplied with female NPT connections at both ends for piping. Standard piping connection procedures should be followed when installing the valve in the pipeline.

OPERATION

E.V.R. Petite Pinch Valves have a very simple operating process.

- flow passes smoothly through the full port elastomer sleeve
- to close the valve, apply air to the 1/4”NPT connection

Note : **DO NOT** use excessive air pressure to operate the valve. This may damage the elastomer sleeve. Always control the supply pressure with a pressure regulator.

See **Table 1.0 & 1.1** for recommended internal & closing pressures.

Table 1.0 - CLOSING PRESSURE (TU & SE)

SIZE	ID	OD		FF		WORK PRESSURE (psig)	CLOSING PRESSURE	
		TU	SE	TU	SE		PGR	SYNTH.
01	1/4	2 1/4	1 1/2	4	3	60	25	35
02	3/8	2 5/8	2 1/8	4 1/2	3 1/2	60	25	35
03	1/2	2 5/8	2 1/8	4 1/2	3 1/2	60	25	35
04	3/4	3	2 1/4	5 1/4	4	60	25	35
05	1	3 9/16	2 1/2	6 1/4	4 1/2	60	25	35
06	1 1/4	4 3/4	3 3/4	8 3/8	---	50	30	40
07	1 1/2	4 3/4	3 3/4	8 3/8	6 1/2	50	30	40
08	2	6	4	8 3/4	7	50	30	40
09	3	6 5/8	5	9 1/2	9	25	35	45

Table 1.1 - CLOSING PRESSURE (MP & QC)

SIZE	ID (in.)	OD (in.)		FF (in.)		WORK PRESSURE (PSIG)	CLOSING PRESSURE	
		MP	QC (AC,AF)	MP	QC		PGR	SYNTH.
03	1/2	2.25	2.5 , 2.125	3.63	5.5	60	25	35
04	3/4		2.75 , 2.25		6.5	60	25	35
05	1	1	3 , 2.5	4.6	7	60	25	35
07	1 1/2		4.5 , 3.75		9	50	30	40
08	2		5 , 4		10	50	30	40
09	3		6.25 , 5		12	25	35	45

MAINTENANCE

With no moving parts except the opening & closing of the rubber sleeve, E.V.R. Petite Pinch Valves Type “SE” , “TU” , “QC” , and “MP” are maintenance free. However it is recommended that a replacement sleeve should always be stocked.

Sleeve Replacement

- No sharp instruments (i.e. screwdrivers) to remove or install the sleeve should be used, these may cut or puncture the rubber sleeve
- Disconnect the air supply and remove the valve from the line
- For Type “TU” Petite Pinch Valve the design allows for the removal of just the valve body while leaving the unions piped
- After the end caps or union nuts are loosened, using a flat dull instrument pry under the sleeve flange and simultaneously push the sleeve through the body
- Using a lubricant which is compatible to the process, valve body and the sleeve material, lubricate the out side of the sleeve flange & inside edges of the body
- Collapse the sleeve flange and push it through the body as far as possible
- Using a dull instrument pry under the flange and snap it over the valve seat while pushing the sleeve from the other end
- Once the sleeve is through, use your finger to pull the outer edges of the flange to properly seat the sleeve
- Check both ends for proper seating
- Lubricate flange faces to prevent the sleeve from twisting when the end caps or union nuts are tightened
- Care should be taken not to over tighten the ends (see section under INSTALLATION)
- Reinstall the valve in the line and reconnect air supply